

pureAir 1500



Owner's Manual

Welcome

Thank you for your purchase of the pureAir 1500. This unit has been designed to provide you a cleaner living space with years of low maintenance operation.

Please read through the usage and service instructions outlined in this owner's manual before operating the unit.

Table of Contents

Important Safety Instructions	3
Diagrams	4 - 5
Initial Settings	6
Settings	7
Disassembly/Assembly	8 - 9
Cleaning	10 - 11
Maintenance	12
Troubleshooting	13
Specifications	14
Warranty Information	15

Product Contents

- | | |
|-----------------------|------------------|
| 1 pureAir 1500 Unit | 1 Owner's Manual |
| 1 Power Cord | 1 DC Adapter |
| 1 Remote with Battery | |

Important Safety Instructions



Never operate the unit near a heat source, open flame, or flammable/combustible fluids.



Do not operate the unit unless all parts (including PCO CELL, OZONE PLATE, FILTER ASSEMBLY, and REAR COVER) are properly installed.



Directly viewing the illuminated ultraviolet lamp may result in eye injury. The lamp is not directly visible when mounted in assembled unit.



Do not adjust the purification setting to exceed the square footage of the space being treated.



Do not place device directly facing sitting or sleeping areas.



Do not use device in DEEP CLEAN MODE during planned activity of heavy exertion such as exercising.



Do not use DEEP CLEAN MODE in occupied spaces. Allow for 2 hours following treatment in DEEP CLEAN MODE prior to returning. Short term exposure to ozone levels exceeding 0.05 ppm can cause temporary adverse reactions such as throat irritation, coughing, chest pain, or shortness of breath.



Do not block the ventilation or filters.



The unit should be powered OFF and the POWER ADAPTER disconnected whenever cleaning or servicing.



There are no user-serviceable parts inside the unit.



This unit is not intended for outdoor use.

Diagrams

Unit Front

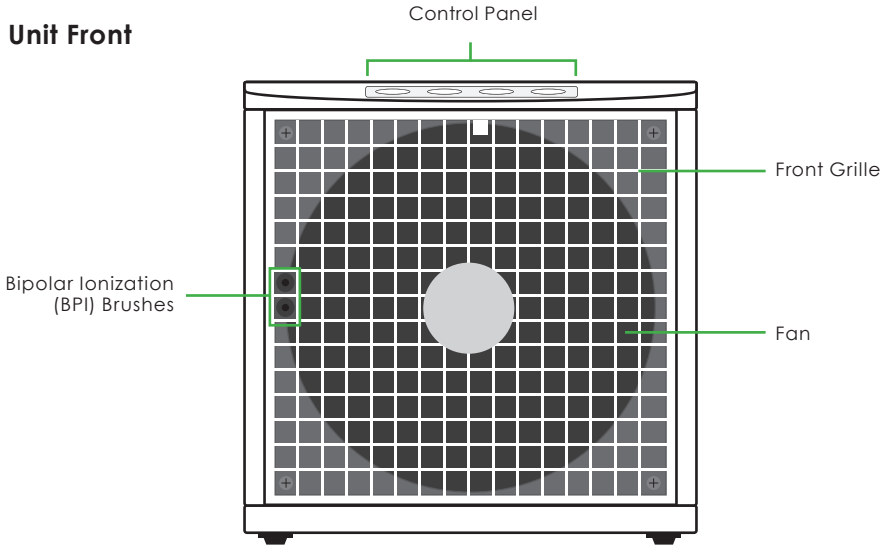

**Unit Rear
(Closed)**

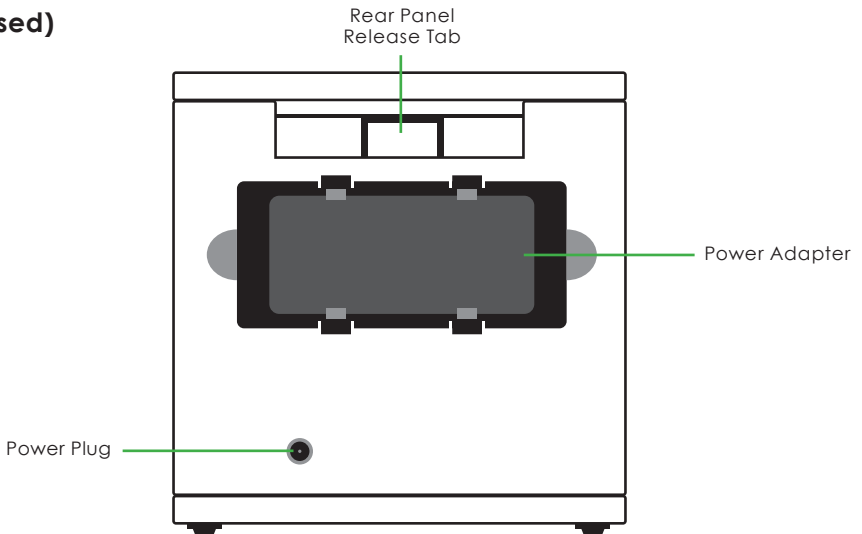

Diagrams

Unit Rear (Open)

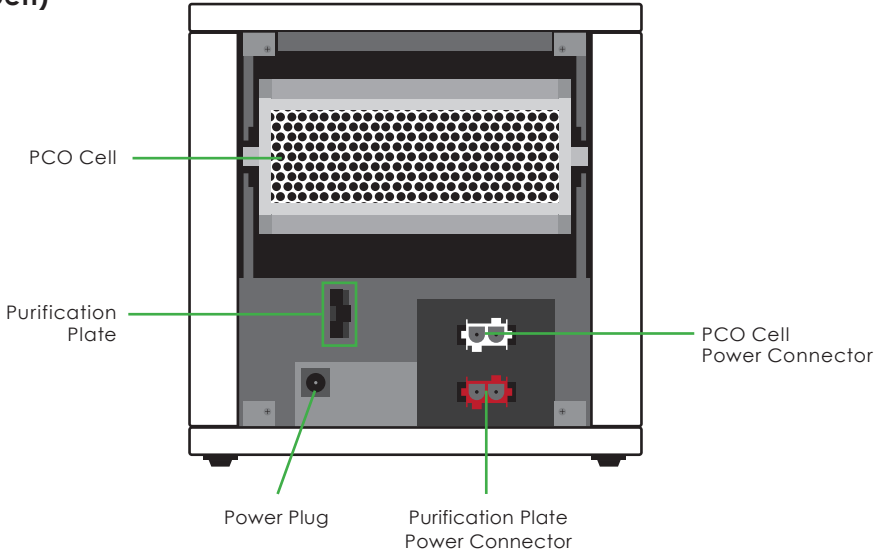

Control Panel

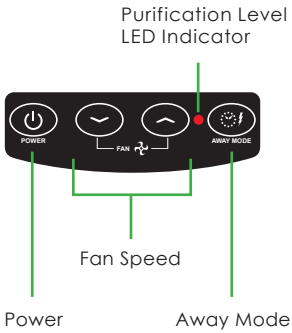

Remote

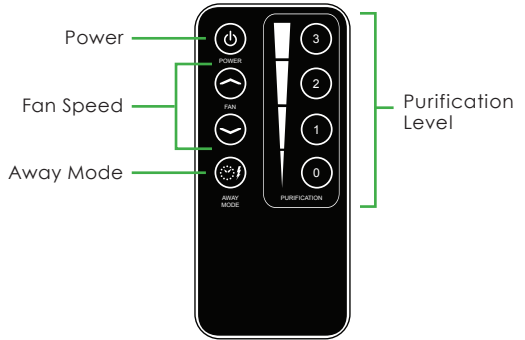

Initial Settings

Before using your pureAir 1500 you will need to find the area (or square footage) of the environment. To do this accurately, take into account all connected rooms with open doorways (the purification does not flow through closed doors). The pureAir 1500 can purify up to 1,500 square feet of space (based upon an open floor plan with 8.5' ceilings).

Once you have determined an ideal location for your unit and calculated the area of the environment:

1. Plug the POWER ADAPTER into a wall outlet and then plug the other end into the POWER PORT of your unit.
2. Place the POWER ADAPTER into the open space in the rear of the unit.
3. Leave the unit at it's beginning setting (PURIFICATION LEVEL 0/FAN SPEED HIGH) for at least 24 hours to begin with.
4. Gradually increase the PURIFICATION LEVEL setting every 12 - 24 hours until you reach your desired setting. Use the next page to estimate your purification level based upon your square footage.
5. While these settings use estimated square footage, we suggest using your sense of smell to confirm your preferred strength. If the setting is too low, you may still notice musty, cooking, animal, or other types of odors. If the setting is too high, you may notice an oxidation smell which some liken to the smell of chlorine. In either case, adjust the PURIFICATION LEVEL on the REMOTE CONTROL until the only smell you notice is a clean, fresh living space.

Settings

There are multiple ways to change the output of your unit. If you need the unit to be quieter, change the Fan Speed, if you need a larger or smaller area covered, change the Purification Level, and if you need a tough odor removed, use Away Mode.

Fan Speed

Three fan speeds are available (Low, Medium, High) and are adjusted with the FAN UP/DOWN buttons on both the machine's CONTROL PANEL as well as with the REMOTE.

Purification Level

Purification level is controlled on the REMOTE and adjusts the output of Activated Oxygen (O₃). Four levels are available and will be signified by varying colors on the CONTROL PANEL.

LEVEL 0 (0 - 250ft²): LED is OFF.



(Level 0 uses only PCO and Ionization Technology.)

LEVEL 1 (250 - 500ft²): LED is GREEN

LEVEL 2 (500 - 1000ft²): LED is YELLOW

LEVEL 3 (1000 - 1500ft²): LED is RED

Deep Clean Mode

Deep Clean Mode is used to treat the toughest odors in your space with higher levels of Activated Oxygen and Ionization. To activate, press the AWAY MODE BUTTON on the CONTROL PANEL or REMOTE.



WARNING: Do not use DEEP CLEAN MODE in occupied spaces. Allow for 2 hours following treatment in DEEP CLEAN MODE prior to returning. Short term exposure to ozone levels exceeding 0.05 ppm can cause temporary adverse reactions such as throat irritation, coughing, chest pain, or shortness of breath.

Away Mode is active for 2 Hours before reverting back to previous settings.

Disassembly



Turn the unit OFF and remove the POWER CORD before performing any cleaning or maintenance to prevent injury.



Refer to the Diagram Section (Pg. 4-5) for further illustrations of part names and locations.

Rear Cover

After unplugging and removing the POWER CORD and POWER ADAPTER, press down on the tab above the POWER ADAPTER space and then pull back on the REAR COVER.

Side Filters

After removing the REAR COVER, slide each of the FILTER ASSEMBLIES straight out. These separate and contain 3 different filter pieces.

Purification Plate

(a) Locate the PURIFICATION PLATE CONNECTOR (Red Connector Piece) on the right side of the unit. Squeeze the tabs on the left and right and gently pull free. **(b)** Grasp the PURIFICATION PLATE, press the tabs towards the middle and slide it out of its slot.

PCO Cell

(a) Locate the PCO CELL CONNECTOR (White Connector Piece) on the right side of the unit. Squeeze the tabs on the left and right and gently pull free. **(b)** Grasp the PCO CELL, and gently pull back to remove it from the slot.

Front Grille

Locate and remove the four FRONT GRILLE SCREWS in the four corners of the FRONT GRILLE using a #1 Phillips Head Screwdriver. Place the screws where you will find them again easily. Remove the FRONT GRILLE carefully to ensure the IONIZATION BRUSH is not damaged.

Assembly



All parts must be properly installed before operating the unit. Failure to do so may damage the unit.

Front Grille

Replace the FRONT GRILLE and the four FRONT GRILLE SCREWS using a Phillips Head Screwdriver. Be careful to not over-tighten the screws or damage the IONIZATION BRUSH.

PCO Cell

(a) Slide the PCO CELL back into the upper slot with the warning at the top, facing out. **(b)** Plug the PCO CELL CONNECTOR back into the WHITE CONNECTOR SLOT.

Purification Plate

(a) Slide the PURIFICATION PLATE back into the small slot with the larger silver side facing to the left. **(b)** Plug the PURIFICATION PLATE CONNECTOR back into the RED CONNECTOR SLOT.

Side Filters

Ensure that the FILTER ASSEMBLIES are snapped together correctly, then replace the SIDE FILTERS in each of the side slots with the rounded edges facing outwards.

Rear Cover

Place the REAR COVER bottom edge into the hinge slot then push forwards until the tab clicks.

Power Cord

Insert the POWER ADAPTER into the rear slot and then replace the POWER CORD in the POWER PORT.

Cleaning

For proper operation, the unit should be cleaned at least once per month.



Turn the unit OFF and remove the POWER CORD before performing any cleaning or maintenance to prevent injury.



Review the Disassembly and Assembly Section (Pg. 8-9) before performing and cleaning and maintenance to prevent damage to the unit.

Unit Exterior

Wipe down the exterior with a damp cloth or use compressed air or a vacuum cleaner to remove dust. A non-abrasive cleaner may be used on the surfaces of the exterior.

Filter Assembly

Clean water or compressed air may be passed through the entire filter assemblies or the individual parts when disassembled. To disassemble the FILTER ASSEMBLIES grasp the sides of the rim and carefully separate the back piece from the housing. The three filters [mesh, foam, honeycomb] can then be removed and cleaned separately. If using water you must allow the filters to fully dry before reassembly. When reassembling, the HONEYCOMB FILTER goes in first, then the FOAM FILTER, and finally the thin MESH FILTER. Then simply reattach the rear piece to the housing.

Cleaning

Unit Interior

Using a damp cloth, a clear alcohol based cleaner, or compressed air/ vacuum cleaner carefully clean the walls and components inside of the unit, after completing the DISASSEMBLY procedures.

PCO Cell

Using compressed air or a vacuum blow/suck the dust out of the PCO Cell. Do not use any liquid to clean the PCO Cell.

Purification Plate

The Purification Plate only needs cleaning every 3 months, unless it is used in a harsh environment (Smoking Area, Kitchen, Pet Area).

Using a 50/50 mix of warm water and clear ammonia, soak the PURIFICATION PLATE from 1-8 hours. Using a soft-bristle brush, scrub the metal center. Rinse thoroughly and allow to dry completely before reinstalling.



All parts must be properly installed before operating the unit. Failure to do so may damage the unit.

Maintenance



Turn the unit OFF and remove the POWER CORD before performing any cleaning or maintenance to prevent injury.



Review the Disassembly and Assembly Section (Pg. 8-9) before performing and cleaning and maintenance to prevent damage to the unit.

General Maintenance

Your unit should need little to no maintenance, besides an occasional PCO Cell or Purification Plate Replacement, but sometimes problems arise. If you can't find a resolution in the Troubleshooting Section (Pg. 13) contact Greentech Environmental for further instructions. (www.GreenTechEnv.com)

PCO Cell Replacement

The PCO CELL does wear out and should be replaced yearly to ensure a high level of efficient cleaning. A replacement can be bought through your Dealer or Greentech Environmental. (www.GreenTechEnv.com)

Purification Plate Replacement

The PURIFICATION PLATE does not wear out as often and will only need to be replaced every 2-3 years of constant use; earlier if you have a harsh environment. A replacement can be bought through your Dealer or Greentech Environmental. (www.GreenTechEnv.com)



Purification Plate



PCO Cell

Troubleshooting

Unit Fails to Turn On

1. Check to make sure that the POWER PLUG, POWER CORD, and POWER ADAPTER are all properly connected.
2. Verify that the POWER BUTTON has been activated on the CONTROL PANEL

If further problems persist, contact Greentech Environmental (www.GreenTechEnv.com) for further instructions or replacement.

Unit is Operating in High or Away Mode, but no Noticeable Purification is Being Produced

1. Ensure that the PURIFICATION PLATE is clean and that its CONNECTOR is fully inserted.
2. View the unit operating in a dark room through the FRONT GRILLE. The PURIFICATION PLATE should have a dim purple glow.

If further problems persist, contact Greentech Environmental (www.GreenTechEnv.com) for further instructions or replacement.

The Purification Plate Generates an Electrical Arc, Arcing Noise, or Burning Odor

The PURIFICATION PLATE is damaged and must be replaced. Contact Greentech Environmental for replacement. (www.GreenTechEnv.com)

The PCO Cell is Not Lighting Up

1. Ensure that the PCO CELL CONNECTOR is properly inserted into its slot.

If further problems persist, contact Greentech Environmental (www.GreenTechEnv.com) for further instructions or replacement.

Fan Does Not Operate Properly

1. Try adjusting the FAN SPEED using the CONTROL PANEL or REMOTE CONTROL.
2. Remove the FRONT GRILLE and ensure there are no obstructions to the movement of the FAN. Clean it thoroughly and also clean the mount that it sits on.

If further problems persist, contact Greentech Environmental (www.GreenTechEnv.com) for further instructions or replacement.

Specifications

Input Voltage 100 - 240VAC | 50/60Hz | 2.5A

Output Voltage 15V DC 3A

Power Consumption. 21W

Unit Dimensions. 6.75'' H x 6.50'' W x 7.00'' D
. (172mm H x 165mm W x 178mm D)

Unit Weight 3 lb
. (1.36 kg)

Activated Oxygen (O₃) Output

Purification Plate 25 - 360 mg/hr

PCO Cell No Ozone

Bipolar Ionization (BPI) Output. 6 KV DC Ion Generator
24 - 30 KV, 20 - 30 Khz Ion Generation Pulsator

Effective Area. Up to 1500 ft² (Open Floor - 8.5' Ceilings)

Warranty 1 Year Manufacturer's Warranty

Warranty Information

Your pureAir 1500 is warranted to be free from all defects in material and workmanship in normal household use for a period of **1 Year** from date of purchase. The warranty is granted only to the original purchaser and members of his or her immediate household. The warranty is subject to the following provisions. Any damages or malfunctions caused by negligence, abuse, or use not in accordance with the Owner's Manual are not covered by this warranty. Likewise, any defects or damages caused by unauthorized service are not covered. Greentech Environmental will, at its option, repair or replace a defective unit that is covered by this warranty. As a matter of warranty policy, Greentech Environmental will not refund the customer's purchase price. To obtain warranty service you must return the defective unit along with proof of purchase to the pureAir Authorized Warranty Station. All transportation charges on parts, or units, submitted under this Warranty shall be borne by purchaser. Unless this Warranty is expressly renewed or extended by Greentech Environmental, any repaired or replaced part of unit shall be warranted to the original purchaser only for the length of the unexpired portion of the original warranty.

FURTHER LIMITATIONS AND EXCLUSIONS ARE AS FOLLOWS:

Any warranty that may be implied in connection with your purchase or use of the unit, including any warranty of merchantability or any warranty for Fitness For A Particular Purpose is limited to the duration of this warranty. Some states do not allow limitations on how long an implied warranty lasts, so the above limitations may not apply to you.

Your relief for the breach of this warranty is limited to the relief expressly provided above. In no event shall Greentech Environmental be liable for any consequential or incidental damages you may incur in connection with your purchase or use of the Unit. Some states do not allow the exclusion or limitation of incidental or consequential damages, so the above limitation or exclusion may not apply to you.

This warranty gives you specific legal rights, and you may also have other rights which vary from state to state.

REGISTRATION

Please register your new pureAir product within 10 days of purchase by visiting:

www.GreenTechEnv.com/Warranty



www.GreenTechEnv.com